

# auditorililla

Some things have to be felt

GENERAL DOSSIER

## Comprehensive care. Flexibility and versatility.

The Auditori L'illa is in L'illa Diagonal, a vast property complex on Barcelona's main thoroughfare. This complex comprises a shopping centre, two hotels, 48,000 m<sup>2</sup> of offices, a car park, two schools, a sports centre and a public park.

It is a hub featuring outstanding urban connections and fast access from the airport and the Ronda ring-roads. The cutting-edge design and quality of the workmanship are evident in every detail both outside and inside the building, making L'illa Diagonal an iconic part of the city's heritage. This vibrant environment is the perfect setting for a wide range of events including conventions, congresses, concerts, conferences and all kinds of exchanges and meetings.

Its design and state-of-the-art technological equipment are the key to its versatility and flexibility. The exceptional quality of its features, such as air-conditioning, PA system, lighting, screening and acoustics, have been painstakingly crafted, positioning it as a unique venue in the city.

It has a total capacity of 597 people, comfortably seated in the stalls (302) and circle (295) with an unbeatable view of the stage from all angles. It also has an area reserved for people with disabilities.

Its spacious foyer affords it an identity of its own and is ideal for hosting exhibitions and laying on food services during breaks or at the end of events. The ground floor's lounge-cum-restaurant is cosy and welcoming and can accommodate commercial exhibitions or catering services for up to 270 guests.

All in all, it is much more than just an auditorium: it is an infrastructure designed to provide its users with comprehensive care through its wide range of services.

# Auditori-Sala Victoria de los Ángeles





### Auditori - Seat numbering

#### Auditorium capacity

Central stalls **192** seats

Side stalls **110** seats

Central circle **135** seats

Side circle **160** seats

Total capacity **597** seats

Reserved for reduced mobility  **4** seats

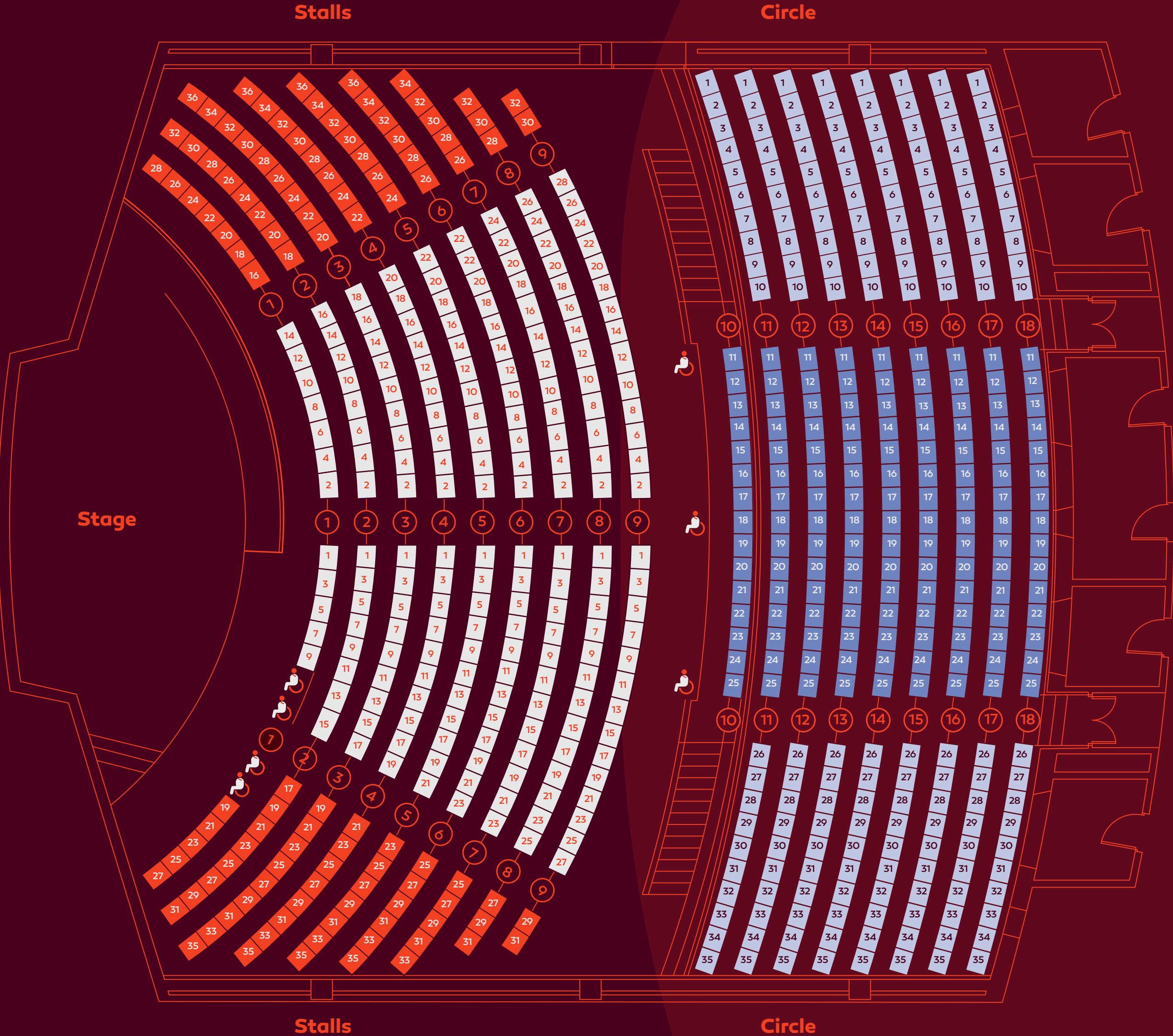

Room 1 \_\_\_\_\_  
**130** pax

Room 2 \_\_\_\_\_  
**40** pax

Rooms 3A+B \_\_\_\_\_  
**80** pax

## Déu i Mata rooms

Meeting and conference rooms that are an independent venue in the same building as the Convention Centre but with direct entry from Déu i Mata Street. Featuring contemporary design and cutting-edge technology, the conference hall, exhibition area, VIP and service areas of this multi-purpose facility boast a pleasant feeling of brightness and well-being which is enhanced by the abundant light flooding in through their windows.

Staging events in this location couldn't be more convenient, easy and original. The rooms' layout can be fully tailored to meet their users' needs, providing a prime setting for mid-scale activities (maximum capacity of 250 people).

# Planta Déu i Mata







### Level -1 Déu i Mata rooms

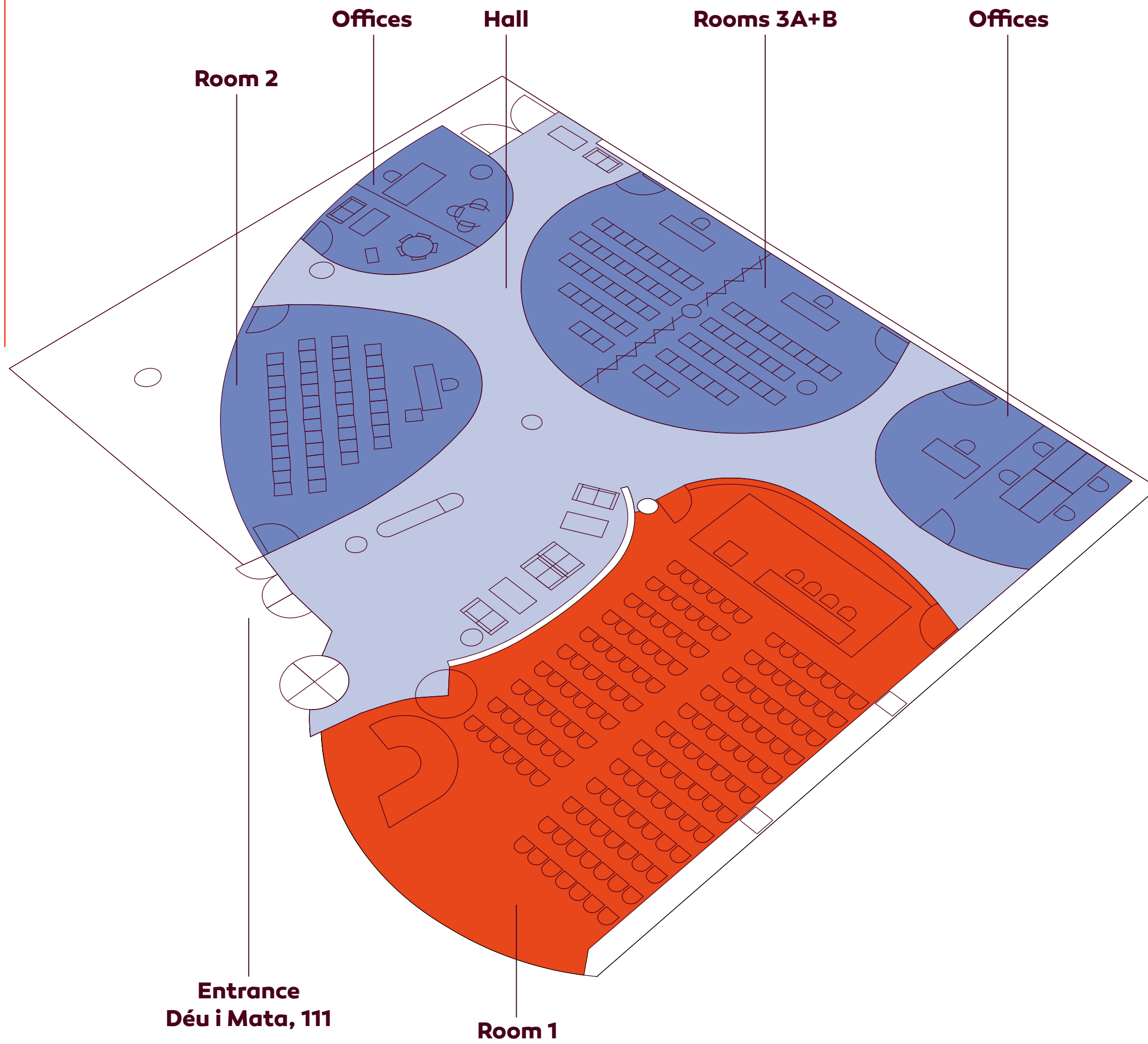

**Level 0  
Sala Win**

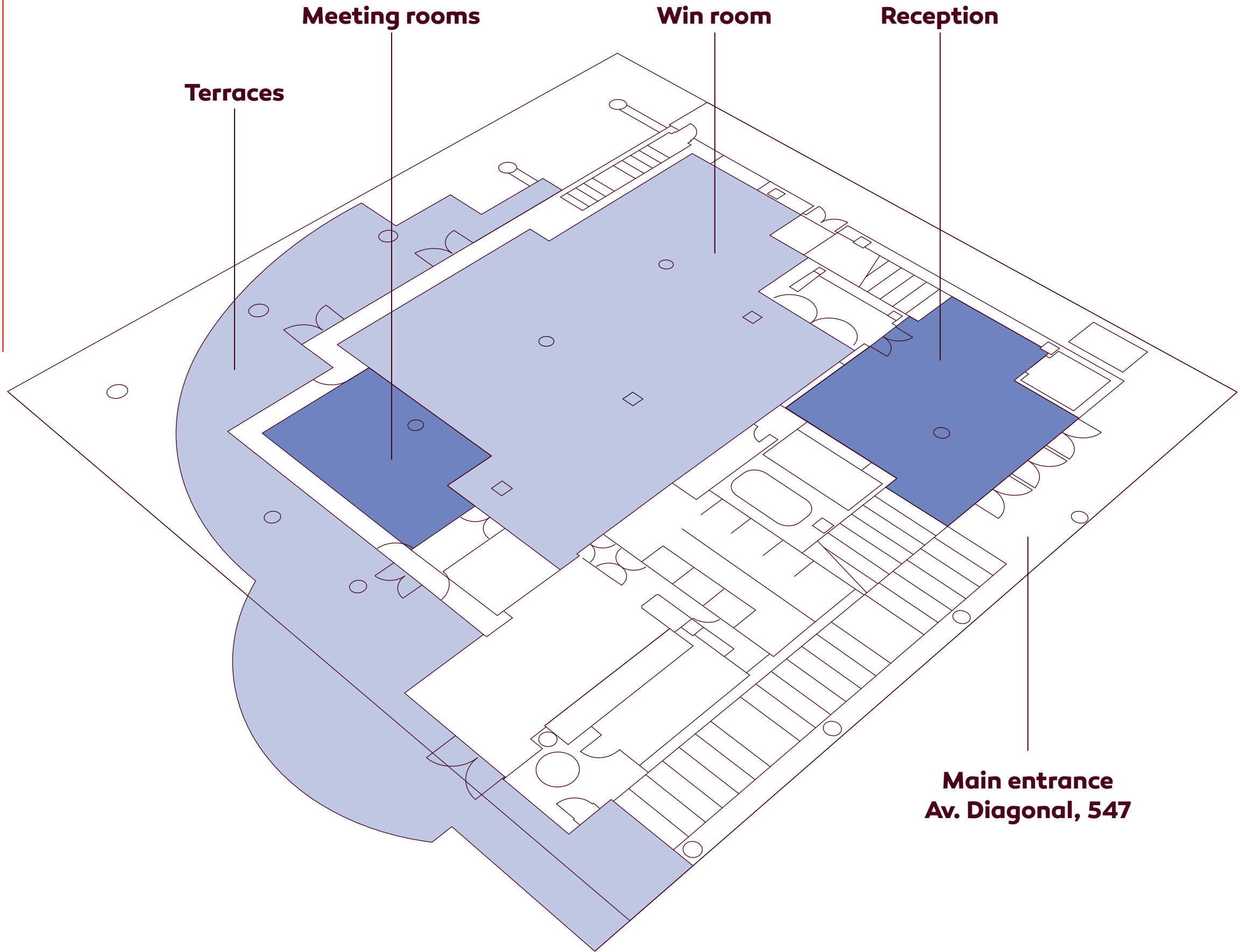

**Level - Auditori**  
**Victoria de los Ángeles level**

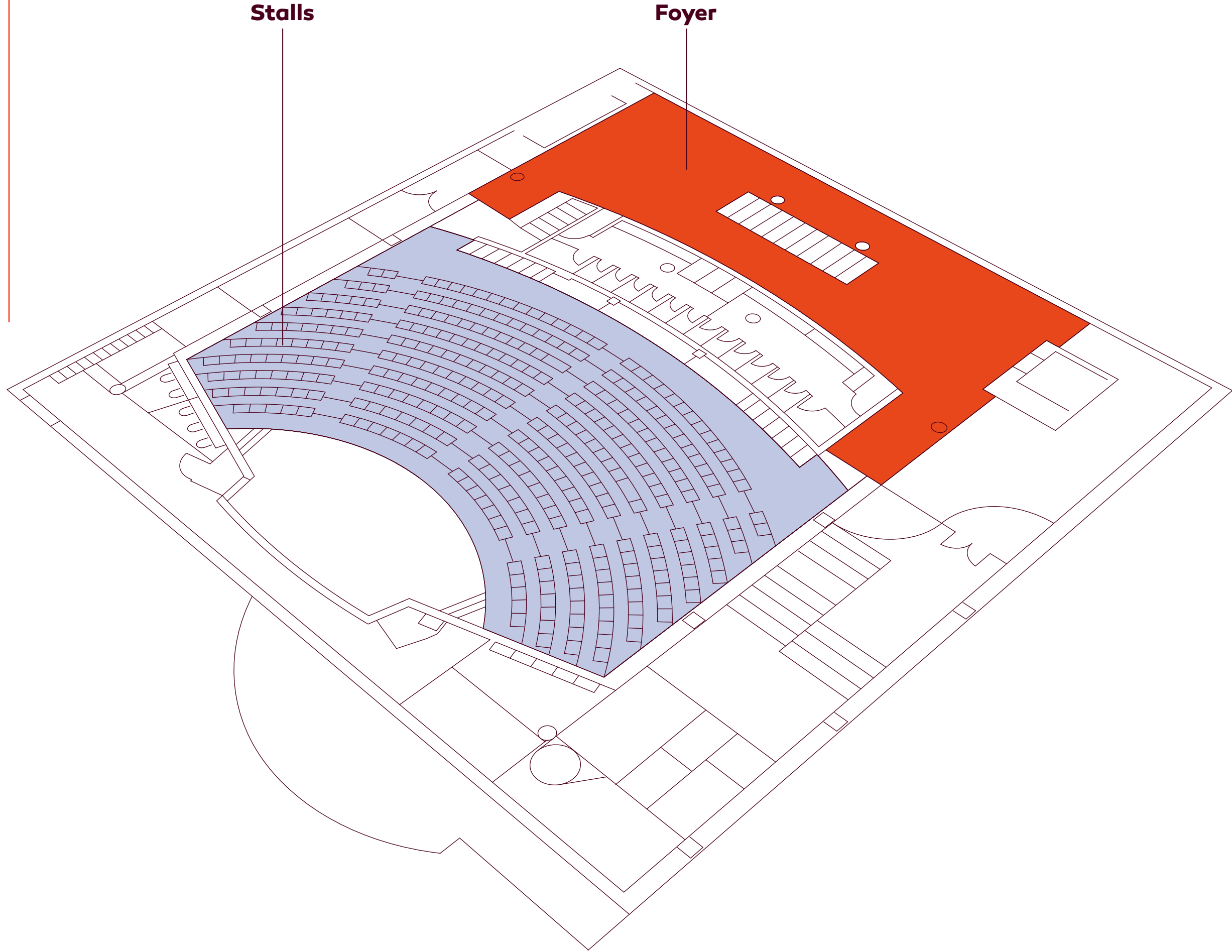

**Level 2  
Technical cabin**

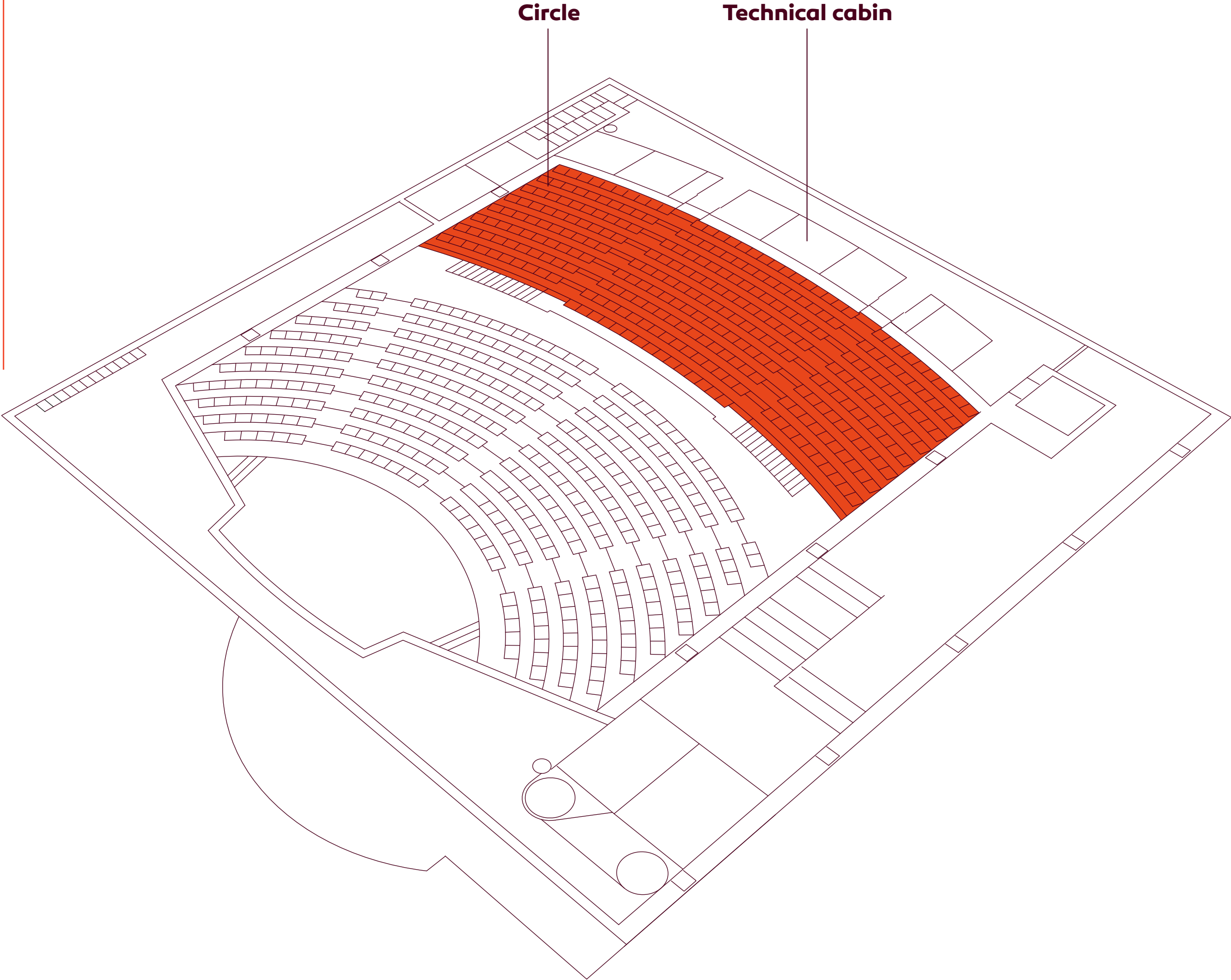



# auditorililla

**Auditori L'illa**  
Av. Diagonal, 547

**Sales Déu i Mata**  
Déu i Mata, 111 (porta giratòria)

**Contact:**  
[info@auditorililla.com](mailto:info@auditorililla.com)  
[dmolina@scce.es](mailto:dmolina@scce.es)  
[atorres@scce.es](mailto:atorres@scce.es)  
[www.auditorililla.com](http://www.auditorililla.com)